

**Part
No.**

**Thread
"T"**

**A
Dia.
[mm]**

**B
max.
[mm]**

**SW
[mm]**

Metrisch / Metric

775-10x1	M 10x1	10,0	20,3	14,0
775-10x1 SS ⁶	M 10x1	10,0	20,3	14,0
775-10x1,25	M 10x1,25	10,0	20,3	14,0
775-10x1,25 SS ⁶	M 10x1,25	10,0	20,3	14,0
775-12x1	M 12x1	12,0	25,0	17,0
775-12x1 L ⁸	M 12x1	12,0	31,0	17,0
775-12x1,5	M 12x1,5	12,0	25,0	17,0
775-12x1,5 L ⁸	M 12x1,5	12,0	31,0	17,0
775-14x1,5	M 14x1,5	14,0	25,0	19,0
775-14x1,5 L ⁸	M 14x1,5	14,0	31,0	19,0
775-16x1,5	M 16x1,5	16,0	29,0	22,0
775-18x1,5	M 18x1,5	18,0	33,0	24,0
775-20x1,5	M 20x1,5	20,0	39,0	27,0
775-22x1,5	M 22x1,5	22,0	39,0	27,0
775-24x1,5	M 24x1,5	24,0	39,0	30,0

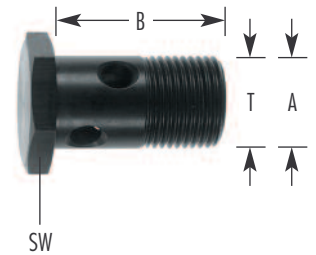

⁶ SS für Edelstahl / SS for stainless steel

⁸ Zur Verwendung mit Ringstück BB / Use with banjos BB