

**Hohlschraube Aluminium
Metrisch**

**Banjo Bolt Aluminium
Metric**



Part No.	Thread „T ₁ “	Thread „T ₂ “	A Dia. [mm]	B max. [mm]	C max. [mm]	SW [mm]
----------	--------------------------	--------------------------	-------------	-------------	-------------	---------

Metrisch mit metrischem Abgang Dichtkegel 60° / Metric with Metric Take Off Cone 60°

774-12x1,5-12x1,5	M 12x1,5	M 12x1,5	12,0	25,2	15,6	17,0
774-12x1,5-12x1,5 L ⁸	M 12x1,5	M 12x1,5	12,0	31,0	15,6	17,0
774-12x1,5-14x1,5	M 12x1,5	M 14x1,5	12,0	25,2	15,8	17,0
774-12x1,5-14x1,5 L ⁸	M 12x1,5	M 14x1,5	12	31,0	15,8	17,0
774-14x1,5-12x1,5 L ⁸	M 14x1,5	M 12x1,5	14,0	31,0	14,2	19,0
774-14x1,5-14x1,5 L ⁸	M 14x1,5	M 14x1,5	14,0	31,0	15,8	19,0

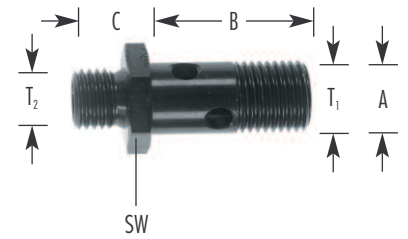

⁸ Zur Verwendung mit Ringstück BB / Use with banjos BB