

**Aufschweißadapter
mit rundem Kopf
Aluminium**

**Weld Adapter
Round Head
Aluminium**

**Part
No.**

**Thread
„T“**

**A
max.
[mm]**

**B
Dia.
[mm]**

**C
Dia.
[mm]**

S.A.E. 37° (JIC/AN)

Weld-03D RH ²	3/8 -24 UNF	20,0	15,0	6,8
Weld-04D RH	7/16-20 UNF	21,5	17,0	7,9
Weld-06D RH	9/16-18 UNF	21,5	18,0	10,0
Weld-08D RH	3/4 -16 UNF	24,1	24,0	14,0
Weld-10D RH	7/8 -14 UNF	26,6	26,0	16,0
Weld-12D RH	1-1/16-12 UN	32,6	32,0	20,0
Weld-16D RH	1-5/16-12 UN	32,0	40,0	26,0

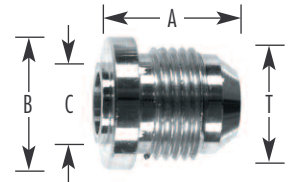

Metrisch (DIN) Dichtkegel 60° / Metric (DIN) cone 60°

Weld-12x1,5 RH ²	M 12x1,5	18,5	17,0	8,0
Weld-14x1,5 RH	M 14x1,5	19,0	19,0	9,6
Weld-16x1,5 RH	M 16x1,5	18,5	21,0	13,0
Weld-18x1,5 RH	M 18x1,5	18,6	23,0	14,0
Weld-22x1,5 RH	M 22x1,5	18,7	27,0	16,0
Weld-26x1,5 RH	M 26x1,5	18,5	31,0	20,0
Weld-30x1,5 RH	M 30x1,5	18,5	35,0	24,0

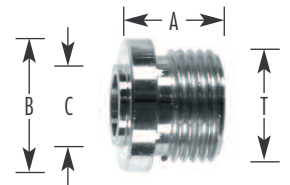

Adapter in Stahl und Edelstahl auf Anfrage / Adaptor stainless steel and steel on request